

# 150002 – Crestview Elementary School

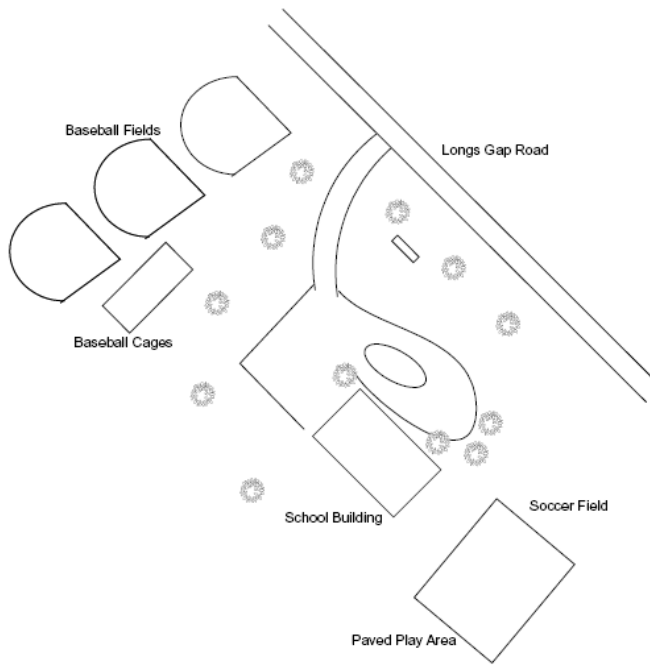

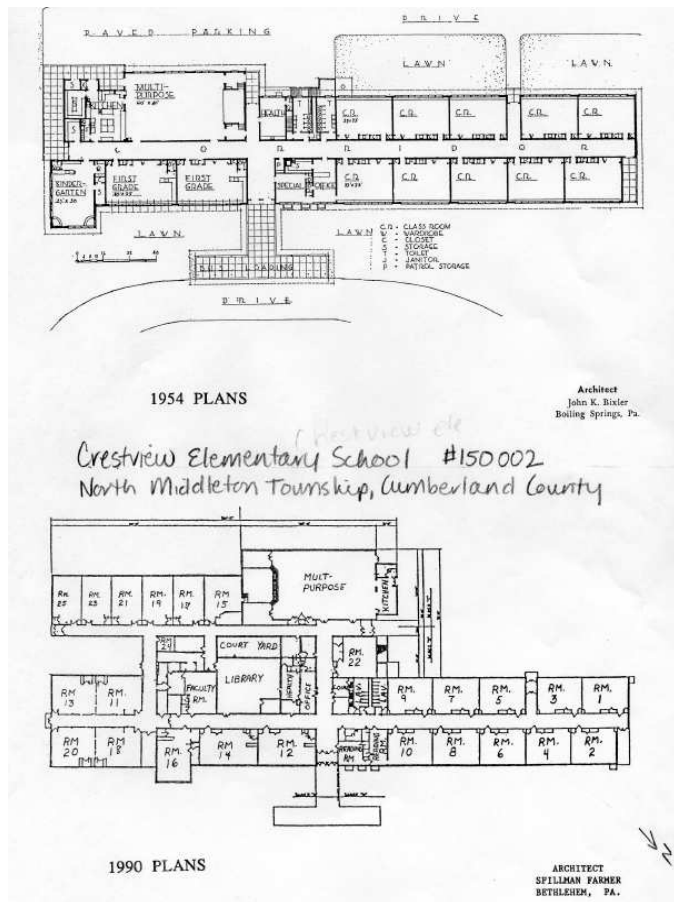

Site Plan for Crestview Elementary



Floor Plan for Crestview Elementary

150002; Crestview Elementary School. This school is located at 240 Longs Gap Road, Carlisle, Pennsylvania, in North Middleton Township, Cumberland County. It is part of the Carlisle Area School District. The 1954 school building is located on a rise above Longs Gap Road, separated from the roadway by a lawn and a circular driveway. The circular drive is lined with trees. A flagpole is located within the grassy interior lawn formed by the driveway. Baseball and soccer fields, playground equipment, and a blacktop area with a basketball court are located on the southeast side of the school building. These are surrounded by expanses of lawn. Baseball fields and batting cages (owned by North Middleton Township) are located northwest of the school building. A landscaped interior courtyard is located on the southeast side of the original school building, between the original building and 1976 and 1990 additions. Paved parking lots are located on the north end of the building. A brick school sign, picnic tables, and shrubs are also located on the property.

The original 1954 one-story school was a rectangular building. The original school has been converted completely to classrooms, most arranged along interior hallways extending outward from the main entry hall. An original multi-purpose room (auditorium/cafeteria/gymnasium) was converted into a library and office space with the construction of a 1990 addition and a new multi-purpose room. The 1954 school building is either a steel or concrete-block reinforced structure, with brick walls. The building sits on a concrete foundation. The flat roof is covered with tar and gravel. An interior brick chimney extends from the roof. The main entrance contains two sets of metal and glass double doors with a transom over each and sidelights. It is sheltered by an original one-story flat-roof steel and aluminum overhang. The building is lit by 1990 double-hung one-over-one windows. A square one-story addition was added to the southeast end of the school in 1976. A rectangular one-story addition was added along the southwest side of the school in 1990. Construction materials of the additions reflect that of the original school building.

The entryway and hallways feature carpeted floors (1990), acoustic ceiling tiles, glazed concrete block walls, and metal and glass doors. Specialty rooms include, or have included, art and music rooms, a kindergarten, and a health office.

The original school building was constructed in 1954 as the North Middleton Township Elementary School to replace seven one-room rural schools. It served kindergarten through eighth grade. From 1955 until 1978, the school housed kindergarten through sixth grade only. Due to increasing population, three portable classroom units were added to the property in 1969; however, these have since been removed. A four-classroom permanent addition was constructed in 1976, identified now as the first grade wing. In 1990 more extensive changes to the property occurred. These include the constructed of a large addition containing a new multi-purpose room and kitchen, six classrooms, a music room, and an art room. The original multi-purpose room was converted in use to a library, among other things. Renovations such as new carpeting and window replacement

occurred throughout the school at this time as well. A paved rear play area and parking lot were moved in 1990 due to the construction of the addition.

(Jim Burgess, pers. com. with Melissa Timo, April 18, 2006.)  
History provided on school website.

United States Geological Survey

1994 *Carlisle NW, PA Aerial Photograph*. USGS Reference Number 40077-a  
a B2-01-PHT. Created on April 18, 1994.

1994 *Carlisle, PA Quadrangle*. 7.5 minute series. Topography compiled  
b 1994. Planimetry derived from imagery taken 1994 and other  
sources. Denver, CO.



*Aerial View of Crestview Elementary School*

More Photos of Crestview Elementary School

